

INSTALLATION INSTRUCTIONS

1

MARK DOOR & BORE HOLES

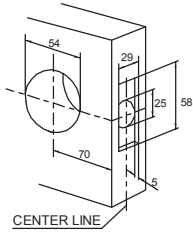

- Fold template over edge of door, mark at 60mm or 70mm for the hole.
- Bore 54mm hole through door and a 25mm hole from the door edge.
- Cut out a 58X26X3mm base for the striker plate.

3

INSTALL THE DOOR HANDLE

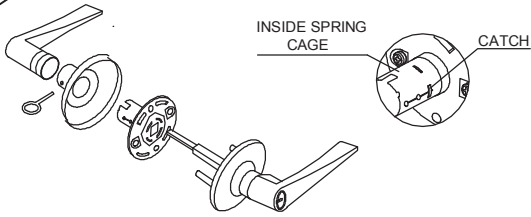

- Find hole on inside lever, use push pin to depress catch and slide off lever.
- Carefully ease off the cover using push pin supplied. DO NOT use heavy duty tools like chisel or screw driver as these may damage the cover.

5

INSTALL INSIDE SPRING CAGE

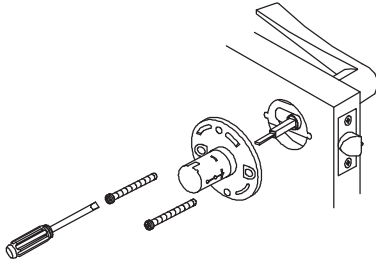

- Position inside spring cage.
- Tighten screws with screw driver.
- DO NOT use power driver.

7

INSTALL STRIKE

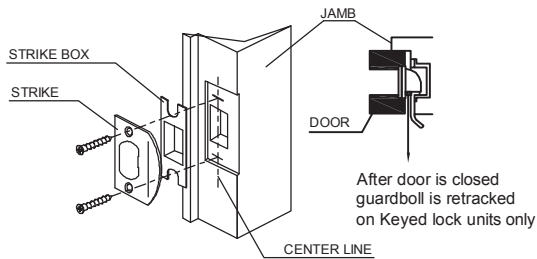

2

INSTALL LATCH

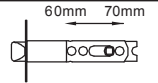

The cam is pushed fully to the right for 70mm backset. Keeping two teeth of the cam to forward always.

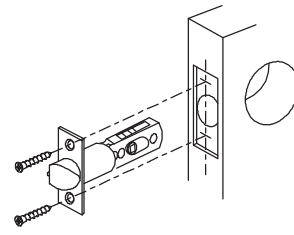

- Adjustable latch for 60mm or 70mm backset.

4

INSTALL OUT SIDE LEVER

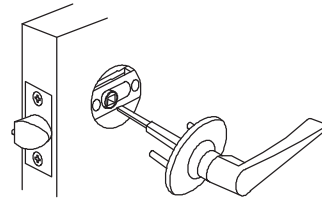

- Place handle into position.

6

INSTALL INSIDE ROSE AND LEVER

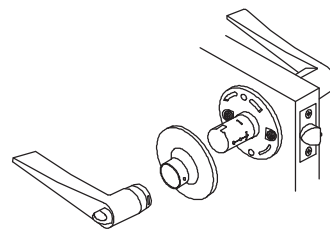

- Push the inside rose onto the spring cage.
- Slide lever on and make sure the catch is fully engaged.

PARTS INCLUDED

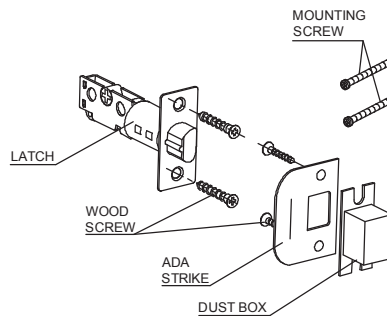

TEMPLATE

Make a 25mm(1") hole in the center of door edge

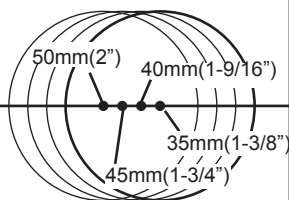

Backset

70mm
60mm

