

# Milano Dummy Set Installation Instruction

- 1 DRILL A 34MM HOLE WITH SPADE BIT ONLY 4MM DEEP INTO THE FACE OF DOOR**

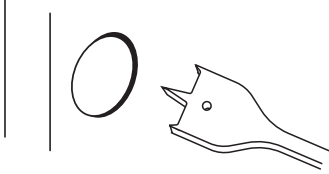

- 2 INSTALL FURNITURE**

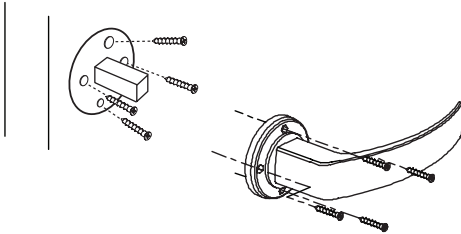

Use wood screws to attach tailor spindle to the door first, then attach furniture with wood screws provided. Tighten the grub screw in the handle.

- 3 FIT EITHER ROUND COVER OR SQUARE COVER**

