

**Very Important!**

This Double Protection Security Set will suit both Left Hand and Right Hand opening doors, it is packaged to suit Right Hand opening. Use the illustration below to determine whether your door is left or right opening. Please fasten all screws by hand and not an electric screwdriver or drill, as over tightening is not recommended.

**Instructions to install the Double Protection Security Set.**  
These instructions suit both Left Hand and Right Hand opening models. Illustrations shown are for right hand opening model. When installing this lever set into a new or existing door you will need the following tools: 25mm spade bit, 12mm and 3mm drill bit, 54mm hole saw, corded or cordless drill, hammer, wood chisel, Phillips head screwdriver, tape and pencil.

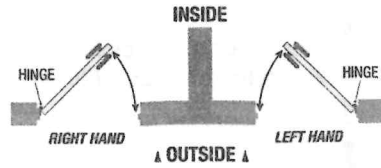

**How to determine if you need a right hand or left hand model:**

Start by facing the outside of the door with the door closed.  
If the hinges are on the left side of the door, you need a right hand model.  
If the hinges are on the right side of the door, you need a left hand model.

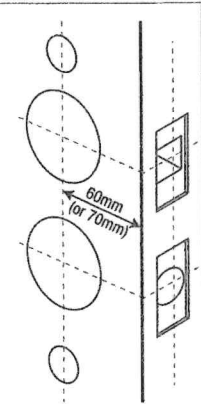

**Step 1: Preparation**

Tape the template right way up on the door at your preferred height and hold in place using tape. Drill a 3mm hole as a guide for the top and bottom handle hole and top and bottom screw hole. Using the centre line for both the door lever and dead bolt, mark the centre line height for both latches on the door edge. Remove template, measure thickness of door and mark the centre point of the door edge. Use a 25mm spade bit to drill an accurate hole through the door edge and using a hole saw, drill a 54mm hole through door front. Accuracy is vital so mark and measure carefully and drill holes level. Use a 12mm drill bit to drill an accurate hole through the top and bottom screw hole previously marked.

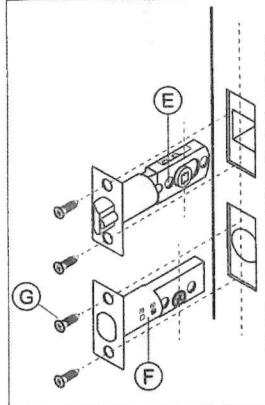

**Step 2: Installing the Latches**

Place Lever Latch (E) into the 25mm hole on the edge of the door and mark the door around the square plate with a pencil. Using a hammer and a chisel, check out the timber so that the latch fits into the newly created recess and finishes flush with door. Once completed push latch into place and drill 3mm pilot holes into the door edge, then simply screw the Timber Screws (G) into place. Repeat for the Deadbolt Latch (F).

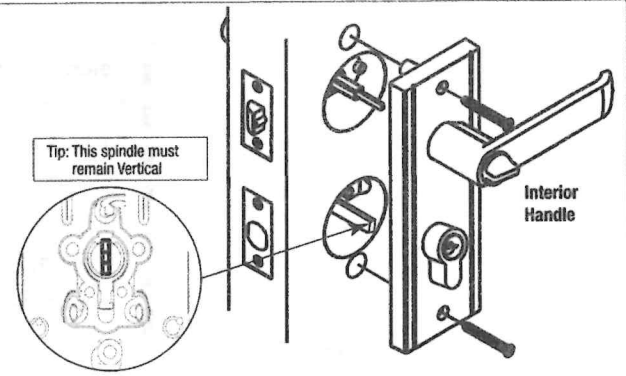
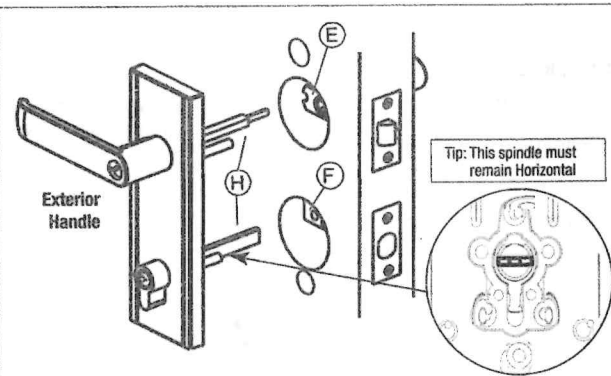

**Step 3: Attaching the Security set to door.**

(Please note: these illustrations are for right hand installation. For left hand installation, please swap exterior and interior handles as appropriate.) Insert the exterior handle with Spindles (H) for both Lever (E) and Deadbolt (F) Latches. Then insert the two screws through from inside the room and tighten firmly. Check that all is working before closing and locking.

**How to convert for Left Hand Opening**

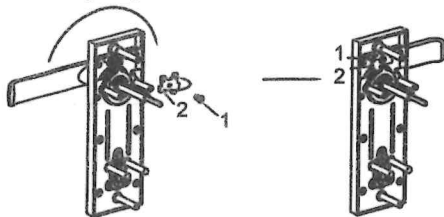

If your door is Left Hand opening follow this easy procedure.  
1. Remove small screw (1) close to the top rear of both door plates and gently pry the metal cover (2) off. Note which way it was attached as when you reattach it you will need to flip it over.  
2. Rotate Handle 180 degrees, attach the metal cover(2) and firmly tighten screw back.

**Handy Hint.**

When removing and replacing the metal cover (2) turn handle 5 degrees, this will release the pressure and ensure easy changeover.

**How to convert Latch from 60mm to 70mm**

Slide tab from the marked 60mm position to the 70mm position.

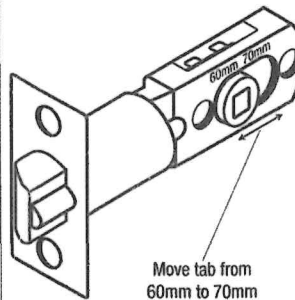

**How to convert Deadbolt Latch from 60mm to 70mm**

Press the tab inside the 60mm square marking (using the aid of a screw driver). Pull the square plate outwards until the tab click in place at the 70mm square marking.

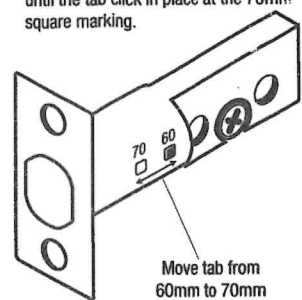

**3 YEARS WARRANTY**

This product is warranted to be free from mechanical defects for 3 years after original purchase. We do not warrant against defects caused by improper installation nor against consequences of use for which our products are not designed. Due to finish limitation, for example, exposure to natural elements, pollution, perspiration, extreme climates, or frequency of use, we do not guarantee the finish of any product, it is considered wear and tear. If a mechanical defect occurs during applicable warranty, return the product to place of purchase with proof of purchase for a free replacement. Our obligation under this warranty is to replace product and in no event shall we be liable for incidental or consequential damages.